

**reflex**

Thinking solutions.

# The new duo in water make-up technology

More convenient handling, more safety in the system



Suitable for new build  
and renovation

Suitable for drinking water  
thanks to lead-free brass alloy

Convenient next generation  
product change because of  
constant dimensions

**Fillset & Fillcontrol Smart** Water make-up technology

[www.reflex-winkelmann.com/en](http://www.reflex-winkelmann.com/en) ■ [info@reflex.de](mailto:info@reflex.de)

# Fillset

## Areas of application

Whether in one-family houses or large industrial systems: the Fillset ensures a clear separation between heating and potable water, protecting against unwanted contaminations. This guarantees compliance with the VDI 2035 potable water standard.



## Benefits

- Suitable for any installation position
- Easily accessible components
- Optionally expandable with water meter
- Optionally expandable with pressure reducer
- Automatic water make-up can be easily retrofitted with Fillset Safecontrol

## Combination options

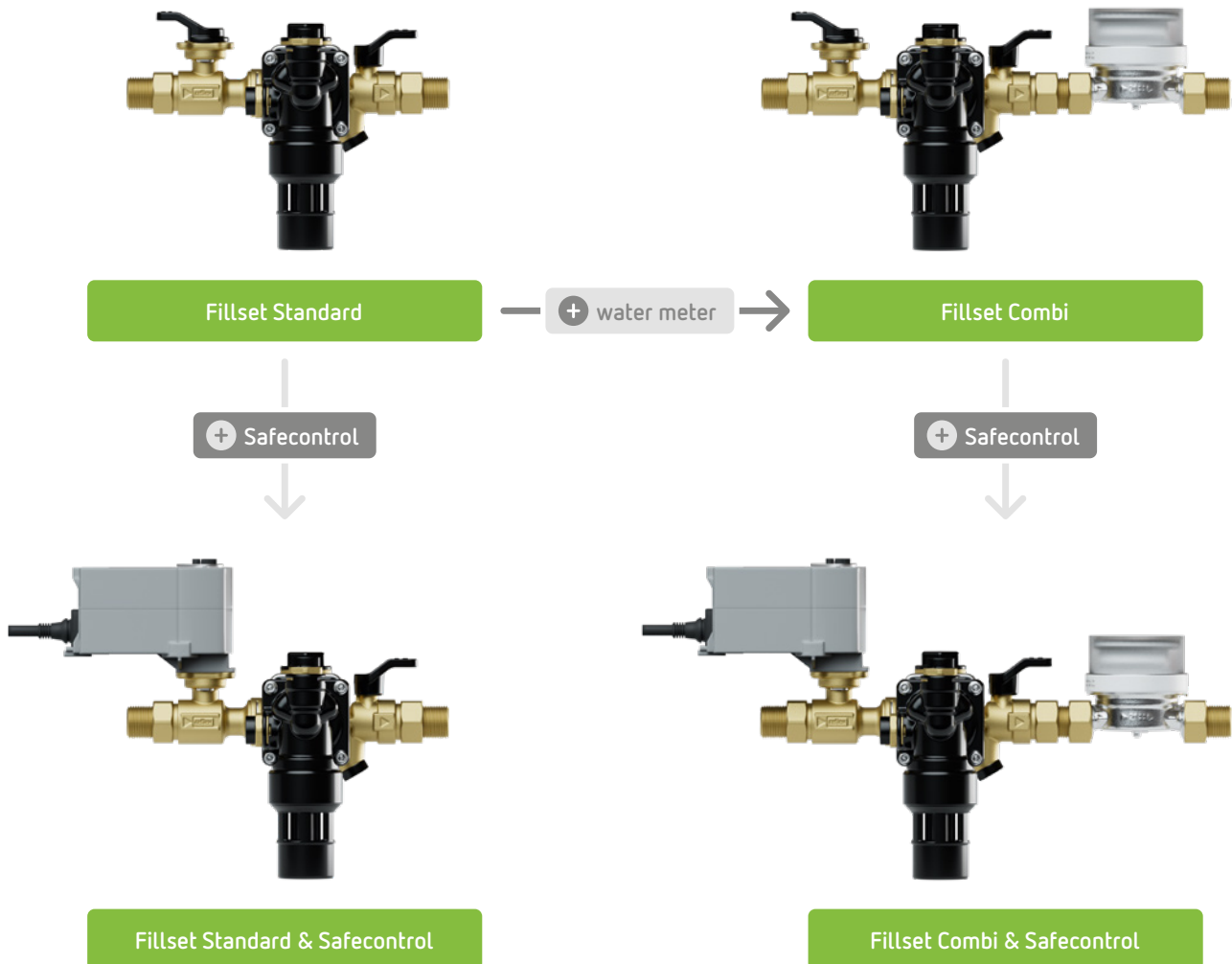

## Technical features



Fillset Standard



Fillset Combi



Fillset Standard & Safecontrol



Fillset Combi & Safecontrol

- connection assembly for water make-up systems according to DIN 1988 and DIN EN 1717
- for direct connection to potable water systems
- with DVGW-tested system separator of Type BA
- isolating fixtures at inlet and outlet
- expandable using Fillset Safecontrol for automatic make-up

- including standard or contact water meter and capacity of the make-up for Fillset Standard approx. 1.6 m<sup>3</sup>/h at  $\Delta p = 1.5$  bar with Fillset Combi approx. 1.2 m<sup>3</sup>/h at  $\Delta p = 1.5$  bar
- minimal flow pressure  $p_0 + 1.5$  bar (deviations possible in combination with Variomat and Servitec)
- max. permissible operating overpressure 10 bar
- max. permissible operating temperature 65 °C

|                 | Type     | Art. No. | Connection inlet/outlet | Height h [mm] | Height including pressure reducer [mm] | Width w [mm] | Depth D [mm] | Weight [kg] |
|-----------------|----------|----------|-------------------------|---------------|--|--------------|--------------|-------------|
| 10 bar<br>60 °C | Standard | 6813100  | R ½"/R ½"               | 170           | 204                                    | 236          | 128          | 1.70        |
|                 | Combi    | 6813105  | R ½"/R ½"               | 170           | 204                                    | 314          | 150          | 2.26        |

## Fillset accessories

### Pressure reducer

- reduces and stabilises the pressure of water flowing through the system
- ensures a constant pressure discharge, independent of any input pressure fluctuations
- protects the system against damage caused by overpressure and contributes to system efficiency and safety by preventing water hammer



### Pulse generator

- the generated pulses are transmitted to an external reading device or a data acquisition system (e.g. BMS), thus enabling accurate monitoring and remote reading of water consumption without any need for direct access to the meter
- to increase the range of use of the water meter



### Pressure gauge

- black casing
- not necessary
- diameter: 63 mm
- connection: R 1/4"



### Safecontrol

- the actuator motor can be connected to the existing motor mount of the Fillset Standard, Combi or Fillcontrol Smart
- the dirt-resistant motor-controlled ball valve is closed by a spring without any need for an electrical supply
- hydraulic and electrical connections must be made on-site
- actuation can be performed via the Fillcontrol Smart or a separate Reflex control unit



### Wall mounts

- suitable for wall-mounted installation of the Fillset Standard, Combi or the FillControl Smart
- depending on the site conditions, a wall-mounted installation can optionally ensure that the overall aesthetic of the entire system is ordered and tidy



### Water meter

- the water meter displays the measured water consumption on an analogue dial
- enables monitoring of the made up water volume



| Type             | Art. No. | Weight [kg] |
|------------------|----------|-------------|
| Pressure reducer | 9131440  | 0.13        |
| Pressure gauge   | 7111539  | 0.00        |
| Wall mounts      | 9131442  | 0.33        |
| Water meter      | 7131225  | 0.39        |
| Pulse generator  | 9131441  | 0.06        |
| Safecontrol      | 7131422  | 0.60        |

The water meter and pulse generator are to be regarded as upgrade accessories, to upgrade to the next higher product variant.

# Fillcontrol Smart

## Areas of application

In all systems with static pressure maintenance and no integrated system controller, Fillcontrol Smart provides support through automatic water make-up.



## Benefits

- Automatic water make-up included
- Intuitive and user-friendly handling via app control
- Pre-installed RS-485 interface
- Easily accessible components
- Stable bluetooth connection
- Easy to extend with Fillguard, pressure sensor or Fillsoft

## Composition

### 1. Fillset Safecontrol

The motor for controlled actuation of the dirt-resistant water make-up valve for safe water make-up without pressure surges is closed without power by spring force.

### 2. Fillset Standard

The connection set for water make-up systems when directly connected to potable water system ensures that the potable water system is protected from possible impurity by reliably preventing the backflow of system water.

### 3. Pressure Sensor

The pressure sensor continuously measures the pressure in the system. If the pressure falls below a certain level, the sensor signals this to the control unit. This allows the sensor to provide information about the condition of the system, e.g., about possible leakages or faults, and to protect the system.

### 4. Controller

The controlled, pressure-dependent water make-up is carried out with automatic interruption and fault message if the runtime is exceeded.

The initial and subsequent filling of the system is facilitated by an adjustable operating mode. Function control and monitoring of the unit are carried out via a fully automatic, freely parametrisable microprocessor controller with LCD display for all relevant operating and fault messages and pressure display, RS-485 interface, as well as potential free output for group fault message.



## Technical features



### Fillcontrol Smart

- compact automatic water make-up station, suitable for systems with a membrane expansion vessel according to DIN 1988 and DIN EN 1717
- with DVGW-tested system separator of Type BA
- Control Smart controller
- RS-485 interface, optional connection of bus and expansion modules
- capacity monitoring of a Fillsoft water treatment system possible
- controlled make-up using the Fillset Safecontrol motor ball valve
- connection voltage 230 V/50 Hz
- water make-up capacity approx. 1.6 m<sup>3</sup>/h at  $\Delta p = 1.5$  bar
- minimal flow pressure  $p_0 + 1.5$  bar
- permissible maximum inlet pressure 10 bar

|                 | Type  | Art. No. | Connection inlet/outlet | Height h [mm] | Width w [mm] | Depth D [mm] | Weight [kg] |
|-----------------|-------|----------|-------------------------|---------------|--------------|--------------|-------------|
| 10 bar<br>65 °C | Smart | 6813500  | R ½" / R ½"             | 299           | 320          | 194          | 3.20        |

## Fillcontrol Smart accessories

### Pressure reducer

- reduces and stabilises the pressure of water flowing through the system
- ensures a constant pressure discharge, independent of any input pressure fluctuations
- protects the system against damage caused by overpressure and contributes to system efficiency and safety by preventing water hammer



### Pulse generator

- the generated pulses are transmitted to an external reading device or a data acquisition system (e.g. BMS), thus enabling accurate monitoring and remote reading of water consumption without any need for direct access to the meter
- to increase the range of use of the water meter



### Wall mounts

- suitable for wall-mounted installation of the Fillset Standard, Combi or the FillControl Smart
- depending on the site conditions, a wall-mounted installation can optionally ensure that the overall aesthetic of the entire system is ordered and tidy



### Pressure gauge

- black casing
- not necessary
- diameter: 63 mm
- connection: R 1/4"



### Water meter

- the water meter displays the measured water consumption on an analogue dial
- enables monitoring of the made up water volume



| Typ              | Art. No. | Weight [kg] |
|------------------|----------|-------------|
| Pressure reducer | 9131440  | 0.13        |
| Pressure gauge   | 7111539  | 0.00        |
| Wall mounts      | 9131442  | 0.33        |
| Water meter      | 7131225  | 0.39        |
| Pulse generator  | 9131441  | 0.06        |

## More information



Further information can be found in the brochure  
Water make-up systems & Water treatment technology

Further product literature and materials can be  
downloaded at or hard copies ordered from  
[www.reflex-winkelmann.com/en/services/documents-and-videos](http://www.reflex-winkelmann.com/en/services/documents-and-videos)

REZ480en / 9131562 / 02-2025  
Subject to technical modifications



Thinking solutions.

**Reflex Winkelmann GmbH**  
Gersteinstrasse 19  
DE-59227 Ahlen  
+49 2382 7069-0  
info@reflex.de

[www.reflex-winkelmann.com/en](http://www.reflex-winkelmann.com/en)